

## 0.2m/0.7ft standard dual-polarized antenna specification

### Electrical performance:

Antenna Model	Antenna Size(m/ft)	Frequency (GHz)	Gain(dBi)			3dB BW (degs)	XPD (dB)	VSWR	F/B radio (dB)	ISO
			Low	Mid	Top					
CMP0213DA	0.2m/0.7ft	12.2-13.25	26.2	26.6	26.9	7.3	30	1.3	52	35
CMP0215DA	0.2m/0.7ft	14.4-15.35	27.4	27.8	28.2	6.5	30	1.3	53	35
CMP0218DA	0.2m/0.7ft	17.7-19.7	29.5	29.9	30.3	5.1	30	1.3	56	35
CMP0223DA	0.2m/0.7ft	21.2-23.6	31.0	31.5	32.0	4.3	30	1.3	57	35
CMP0226DA	0.2m/0.7ft	24.2-26.5	32.2	32.6	33.0	3.8	30	1.3	58	35
CMP0228DA	0.2m/0.7ft	27.5-29.5	33.3	33.6	33.9	3.4	30	1.3	59	35
CMP0232DA	0.2m/0.7ft	31.8-33.4	34.6	34.8	35.0	3.0	30	1.3	60	35
CMP0238DA	0.2m/0.7ft	37.0-40.0	35.9	36.2	36.5	2.5	30	1.3	61	35

### Mechanical performance:

Diameter of Mounting Pole	Φ51~Φ114 mm
Fine Azimuth Adjustment	Coarse 360° Fine ±15°
Fine Elevation Adjustment	Coarse ±25° Fine ±15°
Wind Velocity Operational	180km/h
Wind Velocity Survival Rating	250km/h
Ice-load	25.4 mm
Operational Temperature	-55~ +70°C

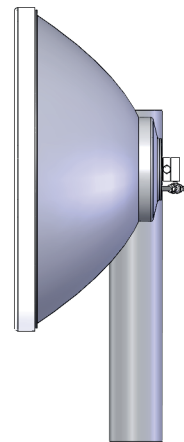

1.The low/mid/high gain has  $\leq -0.5$ dBi tolerance is within the normal range;

2.F/B radio: Denotes highest radiation relative to the main beam, at  $180^\circ \pm 40^\circ$ , across the band. Production antennas do not exceed rated values by more than 2 dB unless stated otherwise;