

## 0.6m/2ft standard dual-polarized antenna specification

### Electrical performance:

Antenna Model	Antenna Size(m/ft)	Frequency (GHz)	Gain(dBi)			3dB BW (degs)	XPD (dB)	VSWR	F/B radio (dB)	ISO
			Low	Mid	Top					
5G30	0.6/2ft	5.0-7.0	30			6	25	1.7	40	30
CMP066WDA	0.6m/2ft	5.925-7.125	29.1	29.9	30.7	5.2	30	1.3	55	35
CMP067WDA	0.6m/2ft	7.125-8.5	30.7	31.5	32.2	4.3	30	1.3	56	35
CMP0610WDA	0.6m/2ft	10.0-11.7	33.6	34.3	35.0	3.0	30	1.3	59	35
CMP0613WDA	0.6m/2ft	12.2-13.25	35.3	35.7	36.1	2.6	30	1.3	60	35
CMP0615DA	0.6m/2ft	14.4-15.35	36.8	37.1	37.4	2.3	30	1.3	62	35
CMP0618DA	0.6m/2ft	17.7-19.7	38.6	39.1	39.5	1.8	30	1.3	64	35
CMP0623DA	0.6m/2ft	21.2-23.6	40.2	40.6	41.1	1.5	30	1.3	65	35
CMP0626DA	0.6m/2ft	24.2-26.5	41.3	41.7	42.1	1.3	30	1.3	67	35
CMP0628DA	0.6m/2ft	27.5-29.5	42.4	42.7	43.0	1.2	30	1.3	68	35
CMP0632DA	0.6m/2ft	31.8-33.4	43.7	43.9	44.1	1.0	30	1.3	69	35
CMP0638DA	0.6m/2ft	37.0-40.0	45.0	45.3	45.7	0.9	30	1.3	70	35

### Mechanical performance:

Diameter of Mounting Pole	Φ51~Φ114 mm
Fine Azimuth Adjustment	Coarse 360° Fine ±15°
Fine Elevation Adjustment	Coarse ±25° Fine ±15°
Wind Velocity Operational	180km/h
Wind Velocity Survival Rating	250km/h
Ice-load	25.4 mm
Operational Temperature	-55~ +70°C

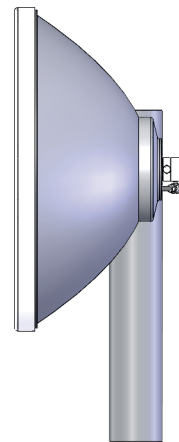

1.The low/mid/high gain has  $\leq -0.5$ dBi tolerance is within the normal range;

2.F/B radio: Denotes highest radiation relative to the main beam, at  $180^\circ \pm 40^\circ$ , across the band. Production antennas do not exceed rated values by more than 2 dB unless stated otherwise;